

INSTALLATION OF THE COVER HP ON COMBIFLEX CX250 BRAKES

Before installing the cover verify that on the front of the brake housing there are the 8 holes shown here below.

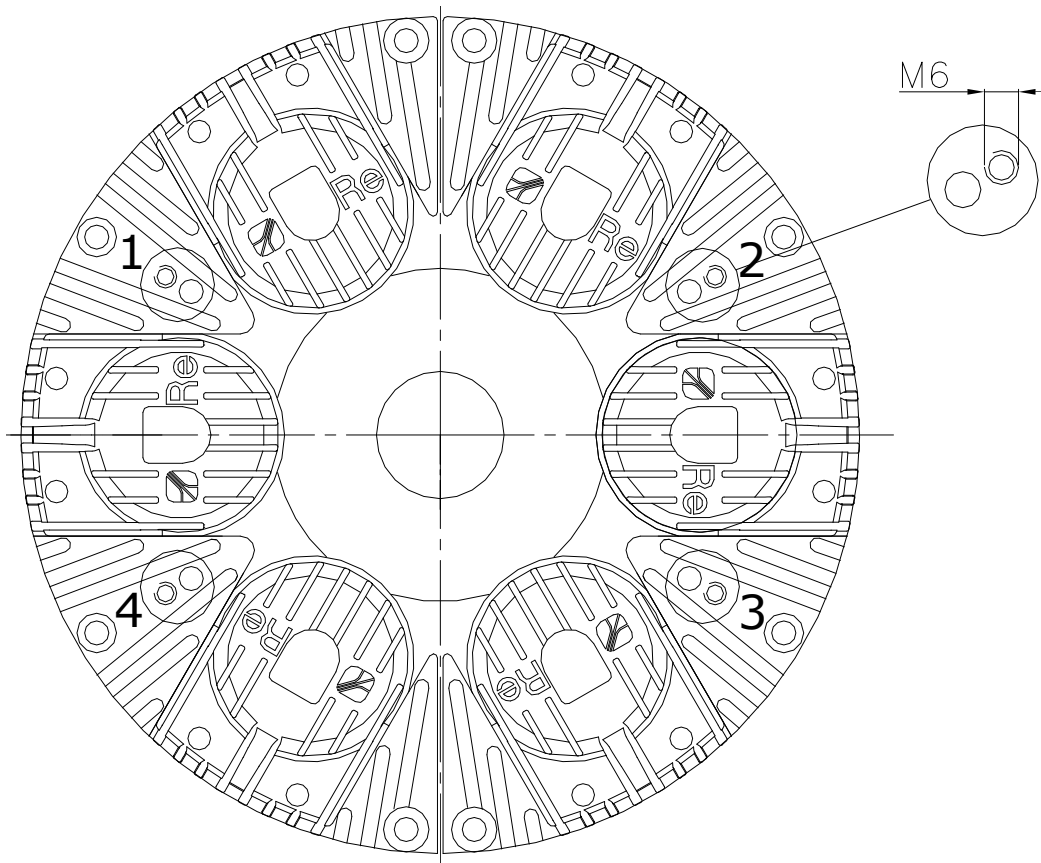

Verified the presence of 8 holes (in the position 1, 2, 3 and 4), make sure that the outer holes are threaded; if they are not, thread M6.

Attention! The brakes produced before year 1987 may not have 8 holes; in this case, use the cover as a drilling mask: position the drilling mask on the brake and run the 4 holes with 5mm tip diameter, then run the tread M6.

If you have a CX251 brake (which is provided with the electro-pneumatic box), remove the box and mount the protective case.

If you would continue to use the proximity application, you must also replace the central disc with the new model disc before installing the appropriate HP cover with proximity.

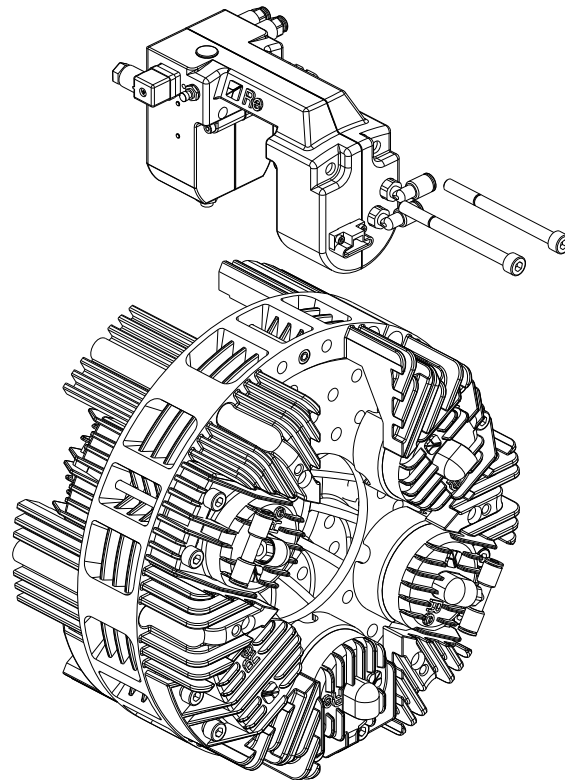

INTERNAL CASE
code 4253310

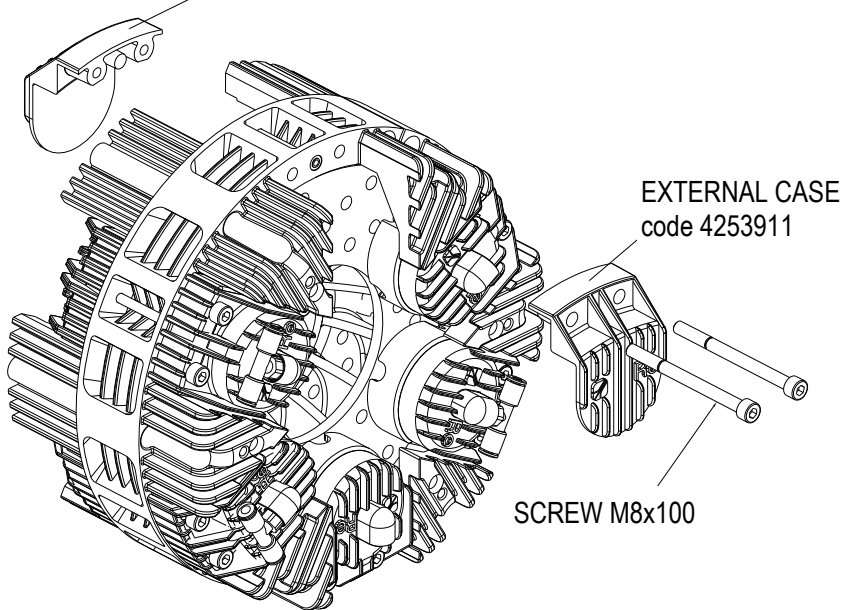

EXTERNAL CASE
code 4253911

SCREW M8x100

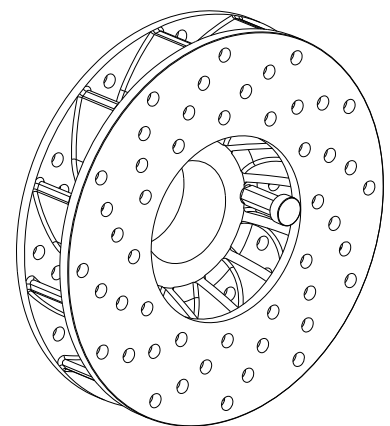

Mount on the brake the standard cover HP (or the cover HP with proximity), using the screws (you can find them inside the cardboard box) as shown below.

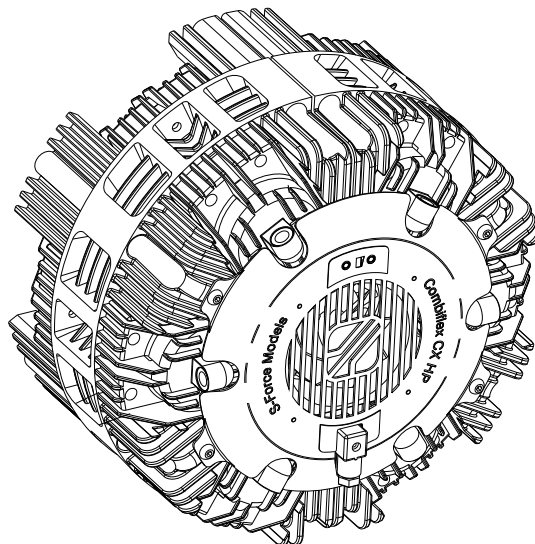
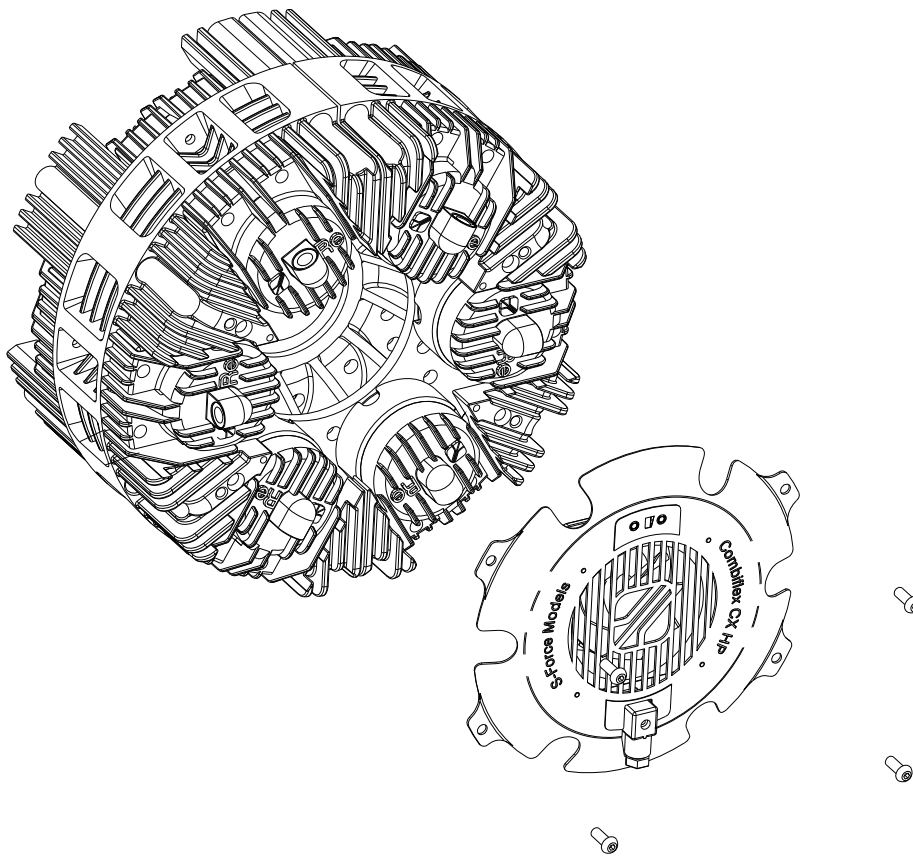

After installing the cover, wire the connector that you find in the cardboard box.

Connection diagram for **standard cover**:

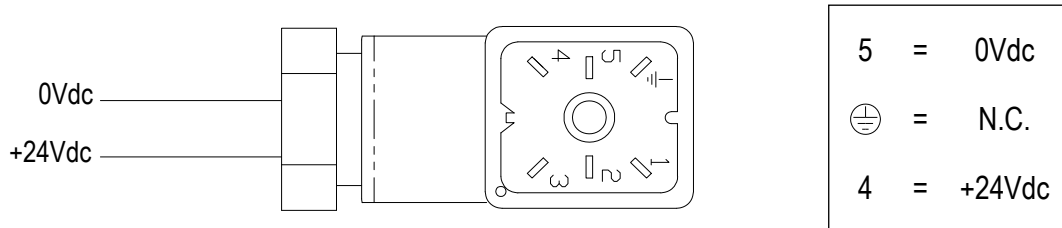

Connection diagram for **cover HP with proximity**:

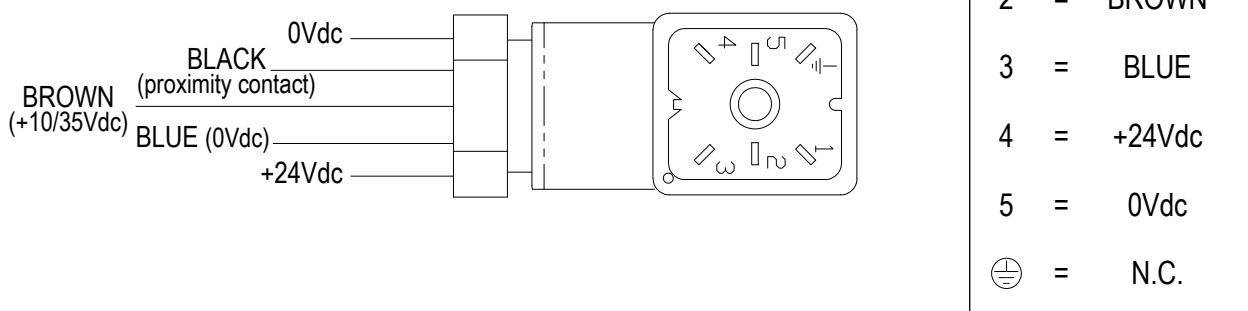

Note: There are 3 different types of HP cover:

<i>Model</i>	<i>Power supply</i>	<i>Absorption</i>
COVER HP1	24V	0,84A
COVER HP2	24V	1,25A
COVER HP3 EDM	24V	2,1A

INSTALLATION COVER HP POWER

